

REFERENCE: SF-950045

PROJECT: 17BP.4.R.104

STATE OF NORTH CAROLINA
DEPARTMENT OF TRANSPORTATION
DIVISION OF HIGHWAYS
GEOTECHNICAL ENGINEERING UNIT

STRUCTURE
SUBSURFACE INVESTIGATION

COUNTY WAYNE
PROJECT DESCRIPTION BRIDGE NO. 45 ON -L- (SR 1353)
OVER GREAT SWAMP AT STATION 14+93

CONTENTS

SHEET NO.	DESCRIPTION
1	TITLE SHEET
2	LEGEND (SOIL & ROCK)
3	SITE PLAN
4	PROFILE
5-6	BORE LOGS

STATE	STATE PROJECT REFERENCE NO.	SHEET NO.	TOTAL SHEETS
N.C.	SF-950045	1	6

CAUTION NOTICE

THE SUBSURFACE INFORMATION AND THE SUBSURFACE INVESTIGATION ON WHICH IT IS BASED WERE MADE FOR THE PURPOSE OF STUDY, PLANNING AND DESIGN, AND NOT FOR CONSTRUCTION OR PAY PURPOSES. THE VARIOUS FIELD BORING LOGS, ROCK CORES AND SOIL TEST DATA AVAILABLE MAY BE REVIEWED OR INSPECTED IN RALEIGH BY CONTACTING THE N. C. DEPARTMENT OF TRANSPORTATION, GEOTECHNICAL ENGINEERING UNIT AT (919) 707-6850. THE SUBSURFACE PLANS AND REPORTS, FIELD BORING LOGS, ROCK CORES AND SOIL TEST DATA ARE NOT PART OF THE CONTRACT.

GENERAL SOIL AND ROCK STRATA DESCRIPTIONS AND INDICATED BOUNDARIES ARE BASED ON A GEOTECHNICAL INTERPRETATION OF ALL AVAILABLE SUBSURFACE DATA AND MAY NOT NECESSARILY REFLECT THE ACTUAL SUBSURFACE CONDITIONS BETWEEN BORINGS OR BETWEEN SAMPLED STRATA WITHIN THE BOREHOLE. THE LABORATORY SAMPLE DATA AND THE IN SITU (IN-PLACE) TEST DATA CAN BE RELIED ON ONLY TO THE DEGREE OF RELIABILITY INHERENT IN THE STANDARD TEST METHOD. THE OBSERVED WATER LEVELS OR SOIL MOISTURE CONDITIONS INDICATED IN THE SUBSURFACE INVESTIGATIONS ARE AS RECORDED AT THE TIME OF THE INVESTIGATION. THESE WATER LEVELS OR SOIL MOISTURE CONDITIONS MAY VARY CONSIDERABLY WITH TIME ACCORDING TO CLIMATIC CONDITIONS INCLUDING TEMPERATURES, PRECIPITATION AND WIND, AS WELL AS OTHER NON-CLIMATIC FACTORS.

THE BIDDER OR CONTRACTOR IS CAUTIONED THAT DETAILS SHOWN ON THE SUBSURFACE PLANS ARE PRELIMINARY ONLY AND IN MANY CASES THE FINAL DESIGN DETAILS ARE DIFFERENT. FOR BIDDING AND CONSTRUCTION PURPOSES, REFER TO THE CONSTRUCTION PLANS AND DOCUMENTS FOR FINAL DESIGN INFORMATION ON THIS PROJECT. THE DEPARTMENT DOES NOT WARRANT OR GUARANTEE THE SUFFICIENCY OR ACCURACY OF THE INVESTIGATION MADE, NOR THE INTERPRETATIONS MADE, OR OPINION OF THE DEPARTMENT AS TO THE TYPE OF MATERIALS AND CONDITIONS TO BE ENCOUNTERED. THE BIDDER OR CONTRACTOR IS CAUTIONED TO MAKE SUCH INDEPENDENT SUBSURFACE INVESTIGATIONS AS HE DEEMS NECESSARY TO SATISFY HIMSELF AS TO CONDITIONS TO BE ENCOUNTERED ON THE PROJECT. THE CONTRACTOR SHALL HAVE NO CLAIM FOR ADDITIONAL COMPENSATION OR FOR AN EXTENSION OF TIME FOR ANY REASON RESULTING FROM THE ACTUAL CONDITIONS ENCOUNTERED AT THE SITE DIFFERING FROM THOSE INDICATED IN THE SUBSURFACE INFORMATION.

- NOTES:
- THE INFORMATION CONTAINED HEREIN IS NOT IMPLIED OR GUARANTEED BY THE N. C. DEPARTMENT OF TRANSPORTATION AS ACCURATE NOR IS IT CONSIDERED PART OF THE PLANS, SPECIFICATIONS OR CONTRACT FOR THE PROJECT.
 - BY HAVING REQUESTED THIS INFORMATION, THE CONTRACTOR SPECIFICALLY WAIVES ANY CLAIMS FOR INCREASED COMPENSATION OR EXTENSION OF TIME BASED ON DIFFERENCES BETWEEN THE CONDITIONS INDICATED HEREIN AND THE ACTUAL CONDITIONS AT THE PROJECT SITE.

PERSONNEL

C.J. CORNETTE

S.N. ZIMARINO

R.E. SMITH

INVESTIGATED BY T.C. BOTTOMS

DRAWN BY T.C. BOTTOMS

CHECKED BY D.N. ARGENBRIGHT

SUBMITTED BY D.N. ARGENBRIGHT

DATE DECEMBER, 2018



DocuSigned by:
Tyler Bottoms 3/6/2019
48A2D3BD08CF4A6
SIGNATURE DATE

DOCUMENT NOT CONSIDERED FINAL
UNLESS ALL SIGNATURES COMPLETED

NORTH CAROLINA DEPARTMENT OF TRANSPORTATION
DIVISION OF HIGHWAYS
GEOTECHNICAL ENGINEERING UNIT
SUBSURFACE INVESTIGATION
SOIL AND ROCK LEGEND, TERMS, SYMBOLS, AND ABBREVIATIONS

SOIL DESCRIPTION	GRADATION	ROCK DESCRIPTION	TERMS AND DEFINITIONS																																																																																																																																																																																																																																																																																													
<p>SOIL IS CONSIDERED UNCONSOLIDATED, SEMI-CONSOLIDATED, OR WEATHERED EARTH MATERIALS THAT CAN BE PENETRATED WITH A CONTINUOUS FLIGHT POWER AUGER AND YIELD LESS THAN 100 BLOWS PER FOOT ACCORDING TO THE STANDARD PENETRATION TEST (ASTM T 206, ASTM D1586). SOIL CLASSIFICATION IS BASED ON THE AASHTO SYSTEM. BASIC DESCRIPTIONS GENERALLY INCLUDE THE FOLLOWING: CONSISTENCY, COLOR, TEXTURE, MOISTURE, AASHTO CLASSIFICATION, AND OTHER PERTINENT FACTORS SUCH AS MINERALOGICAL COMPOSITION, ANGULARITY, STRUCTURE, PLASTICITY, ETC. FOR EXAMPLE, <i>VERY STIFF, GRAY, SILTY CLAY, MOIST WITH INTERBEDDED FINE SAND LAYERS, HIGHLY PLASTIC, A-7-6</i></p>	<p>WELL GRADED - INDICATES A GOOD REPRESENTATION OF PARTICLE SIZES FROM FINE TO COARSE. UNIFORMLY GRADED - INDICATES THAT SOIL PARTICLES ARE ALL APPROXIMATELY THE SAME SIZE. GAP-GRADED - INDICATES A MIXTURE OF UNIFORM PARTICLE SIZES OF TWO OR MORE SIZES.</p> <p style="text-align: center;">ANGULARITY OF GRAINS</p> <p>THE ANGULARITY OR ROUNDNESS OF SOIL GRAINS IS DESIGNATED BY THE TERMS: ANGULAR, SUBANGULAR, SUBROUNDED, OR ROUNDED.</p>	<p>HARD ROCK IS NON-COASTAL PLAIN MATERIAL THAT WOULD YIELD SPT REFUSAL IF TESTED. AN INFERRED ROCK LINE INDICATES THE LEVEL AT WHICH NON-COASTAL PLAIN MATERIAL WOULD YIELD SPT REFUSAL. SPT REFUSAL IS PENETRATION BY A SPLIT SPOON SAMPLER EQUAL TO OR LESS THAN 0.1 FOOT PER 60 BLOWS IN NON-COASTAL PLAIN MATERIAL. THE TRANSITION BETWEEN SOIL AND ROCK IS OFTEN REPRESENTED BY A ZONE OF WEATHERED ROCK. ROCK MATERIALS ARE TYPICALLY DIVIDED AS FOLLOWS:</p> <p>WEATHERED ROCK (WR) - NON-COASTAL PLAIN MATERIAL THAT WOULD YIELD SPT N VALUES > 100 BLOWS PER FOOT IF TESTED.</p> <p>CRYSTALLINE ROCK (CR) - FINE TO COARSE GRAIN IGNEOUS AND METAMORPHIC ROCK THAT WOULD YIELD SPT REFUSAL IF TESTED. ROCK TYPE INCLUDES GRANITE, GNEISS, GABBRO, SCHIST, ETC.</p> <p>NON-CRYSTALLINE ROCK (NCR) - FINE TO COARSE GRAIN METAMORPHIC AND NON-COASTAL PLAIN SEDIMENTARY ROCK THAT WOULD YIELD SPT REFUSAL IF TESTED. ROCK TYPE INCLUDES PHYLLITE, SLATE, SANDSTONE, ETC.</p> <p>COASTAL PLAIN SEDIMENTARY ROCK (CPS) - COASTAL PLAIN SEDIMENTS CEMENTED INTO ROCK, BUT MAY NOT YIELD SPT REFUSAL. ROCK TYPE INCLUDES LIMESTONE, SANDSTONE, CEMENTED SHELL BEDS, ETC.</p>	<p>ALLUVIUM (ALLUV.) - SOILS THAT HAVE BEEN TRANSPORTED BY WATER. AQUIFER - A WATER BEARING FORMATION OR STRATA. ARENACEOUS - APPLIED TO ROCKS THAT HAVE BEEN DERIVED FROM SAND OR THAT CONTAIN SAND. ARGILLACEOUS - APPLIED TO ALL ROCKS OR SUBSTANCES COMPOSED OF CLAY MINERALS, OR HAVING A NOTABLE PROPORTION OF CLAY IN THEIR COMPOSITION, SUCH AS SHALE, SLATE, ETC. ARTESIAN - GROUND WATER THAT IS UNDER SUFFICIENT PRESSURE TO RISE ABOVE THE LEVEL AT WHICH IT IS ENCOUNTERED, BUT WHICH DOES NOT NECESSARILY RISE TO OR ABOVE THE GROUND SURFACE. CALCAREOUS (CALC.) - SOILS THAT CONTAIN APPRECIABLE AMOUNTS OF CALCIUM CARBONATE. COLLUVIUM - ROCK FRAGMENTS MIXED WITH SOIL DEPOSITED BY GRAVITY ON SLOPE OR AT BOTTOM OF SLOPE. CORE RECOVERY (REC.) - TOTAL LENGTH OF ALL MATERIAL RECOVERED IN THE CORE BARREL DIVIDED BY TOTAL LENGTH OF CORE RUN AND EXPRESSED AS A PERCENTAGE. DIKE - A TABULAR BODY OF IGNEOUS ROCK THAT CUTS ACROSS THE STRUCTURE OF ADJACENT ROCKS OR CUTS MASSIVE ROCK. DIP - THE ANGLE AT WHICH A STRATUM OR ANY PLANAR FEATURE IS INCLINED FROM THE HORIZONTAL. DIP DIRECTION (DIP AZIMUTH) - THE DIRECTION OR BEARING OF THE HORIZONTAL TRACE OF THE LINE OF DIP, MEASURED CLOCKWISE FROM NORTH. FAULT - A FRACTURE OR FRACTURE ZONE ALONG WHICH THERE HAS BEEN DISPLACEMENT OF THE SIDES RELATIVE TO ONE ANOTHER PARALLEL TO THE FRACTURE. FISSILE - A PROPERTY OF SPLITTING ALONG CLOSELY SPACED PARALLEL PLANES. FLOAT - ROCK FRAGMENTS ON SURFACE NEAR THEIR ORIGINAL POSITION AND DISLODGED FROM PARENT MATERIAL. FLOOD PLAIN (FP) - LAND BORDERING A STREAM, BUILT OF SEDIMENTS DEPOSITED BY THE STREAM. FORMATION (FM) - A MAPPABLE GEOLOGIC UNIT THAT CAN BE RECOGNIZED AND TRACED IN THE FIELD. JOINT - FRACTURE IN ROCK ALONG WHICH NO APPRECIABLE MOVEMENT HAS OCCURRED. LEDGE - A SHELF-LIKE RIDGE OR PROJECTION OF ROCK WHOSE THICKNESS IS SMALL COMPARED TO ITS LATERAL EXTENT. LENS - A BODY OF SOIL OR ROCK THAT THINS OUT IN ONE OR MORE DIRECTIONS. MOTTLED (MOT.) - IRREGULARLY MARKED WITH SPOTS OF DIFFERENT COLORS. MOTTLING IN SOILS USUALLY INDICATES POOR AERATION AND LACK OF GOOD DRAINAGE. PERCHED WATER - WATER MAINTAINED ABOVE THE NORMAL GROUND WATER LEVEL BY THE PRESENCE OF AN INTERVENING IMPERVIOUS STRATUM. RESIDUAL (RES.) SOIL - SOIL FORMED IN PLACE BY THE WEATHERING OF ROCK. ROCK QUALITY DESIGNATION (RQD) - A MEASURE OF ROCK QUALITY DESCRIBED BY TOTAL LENGTH OF ROCK SEGMENTS EQUAL TO OR GREATER THAN 4 INCHES DIVIDED BY THE TOTAL LENGTH OF CORE RUN AND EXPRESSED AS A PERCENTAGE. SAPROLITE (SAP.) - RESIDUAL SOIL THAT RETAINS THE RELIC STRUCTURE OR FABRIC OF THE PARENT ROCK. SILL - AN INTRUSIVE BODY OF IGNEOUS ROCK OF APPROXIMATELY UNIFORM THICKNESS AND RELATIVELY THIN COMPARED WITH ITS LATERAL EXTENT, THAT HAS BEEN EMPLACED PARALLEL TO THE BEDDING OR SCHISTOSITY OF THE INTRUDED ROCKS. SLICKENSIDE - POLISHED AND STRIATED SURFACE THAT RESULTS FROM FRICTION ALONG A FAULT OR SLIP PLANE. STANDARD PENETRATION TEST (PENETRATION RESISTANCE) (SPT) - NUMBER OF BLOWS (N OR BPF) OF A 140 LB. HAMMER FALLING 30 INCHES REQUIRED TO PRODUCE A PENETRATION OF 1 FOOT INTO SOIL WITH A 2 INCH OUTSIDE DIAMETER SPLIT SPOON SAMPLER. SPT REFUSAL IS PENETRATION EQUAL TO OR LESS THAN 0.1 FOOT PER 60 BLOWS. STRATA CORE RECOVERY (SCRC) - TOTAL LENGTH OF STRATA MATERIAL RECOVERED DIVIDED BY TOTAL LENGTH OF STRATUM AND EXPRESSED AS A PERCENTAGE. STRATA ROCK QUALITY DESIGNATION (SRQD) - A MEASURE OF ROCK QUALITY DESCRIBED BY TOTAL LENGTH OF ROCK SEGMENTS WITHIN A STRATUM EQUAL TO OR GREATER THAN 4 INCHES DIVIDED BY THE TOTAL LENGTH OF STRATA AND EXPRESSED AS A PERCENTAGE. TOPSOIL (TS) - SURFACE SOILS USUALLY CONTAINING ORGANIC MATTER.</p>																																																																																																																																																																																																																																																																																													
<p style="text-align: center;">SOIL LEGEND AND AASHTO CLASSIFICATION</p> <table border="1" style="width: 100%; border-collapse: collapse;"> <thead> <tr> <th rowspan="2">GENERAL CLASS.</th> <th colspan="7">GRANULAR MATERIALS (≤ 35% PASSING #200)</th> <th colspan="5">SILT-CLAY MATERIALS (> 35% PASSING #200)</th> <th colspan="3">ORGANIC MATERIALS</th> </tr> <tr> <th>A-1</th> <th>A-3</th> <th>A-2</th> <th>A-4</th> <th>A-5</th> <th>A-6</th> <th>A-7</th> <th>A-1, A-2</th> <th>A-3</th> <th>A-4, A-5</th> <th>A-6, A-7</th> <th></th> <th></th> <th></th> <th></th> </tr> </thead> <tbody> <tr> <td>GROUP CLASS.</td> <td>A-1-a</td> <td>A-1-b</td> <td>A-2-4</td> <td>A-2-5</td> <td>A-2-6</td> <td>A-2-7</td> <td>A-4</td> <td>A-5</td> <td>A-6</td> <td>A-7</td> <td>A-7.5</td> <td>A-7.6</td> <td>A-1, A-2</td> <td>A-3</td> <td>A-4, A-5</td> <td>A-6, A-7</td> <td></td> <td></td> <td></td> <td></td> </tr> <tr> <td>SYMBOL</td> <td></td> <td></td> <td></td> <td></td> <td></td> <td></td> <td></td> <td></td> <td></td> <td></td> <td></td> <td></td> <td></td> <td></td> <td></td> <td></td> <td></td> <td></td> <td></td> <td></td> </tr> <tr> <td>% PASSING #10 #40 #200</td> <td>50 MX 30 MX 15 MX</td> <td>50 MX 25 MX 15 MX</td> <td>51 MN 35 MX 35 MX</td> <td>51 MN 35 MX 35 MX</td> <td>51 MN 35 MX 35 MX</td> <td>51 MN 35 MX 35 MX</td> <td>36 MN 36 MN 36 MN</td> <td>36 MN 36 MN 36 MN</td> <td>36 MN 36 MN 36 MN</td> <td>36 MN 36 MN 36 MN</td> <td>36 MN 36 MN 36 MN</td> <td>36 MN 36 MN 36 MN</td> <td>GRANULAR SOILS</td> <td>SILT-CLAY SOILS</td> <td>MUCK, PEAT</td> <td></td> <td></td> <td></td> <td></td> <td></td> <td></td> </tr> <tr> <td>MATERIAL PASSING #40 LL PI</td> <td>-</td> <td>-</td> <td>40 MX 10 MN</td> <td>41 MN 10 MN</td> <td>40 MX 11 MN</td> <td>41 MN 11 MN</td> <td>40 MX 10 MN</td> <td>41 MN 10 MN</td> <td>40 MX 11 MN</td> <td>41 MN 11 MN</td> <td>40 MX 10 MN</td> <td>41 MN 10 MN</td> <td>SOILS WITH LITTLE OR MODERATE AMOUNTS OF ORGANIC MATTER</td> <td>HIGHLY ORGANIC SOILS</td> <td></td> <td></td> <td></td> <td></td> <td></td> <td></td> <td></td> </tr> <tr> <td>GROUP INDEX</td> <td>0</td> <td>0</td> <td>0</td> <td>0</td> <td>0</td> <td>0</td> <td>0</td> <td>0</td> <td>0</td> <td>0</td> <td>0</td> <td>0</td> <td></td> <td></td> <td></td> <td></td> <td></td> <td></td> <td></td> <td></td> <td></td> </tr> <tr> <td>USUAL TYPES OF MAJOR MATERIALS</td> <td>STONE GRAVEL AND SAND</td> <td>FINE SAND</td> <td>SILTY OR CLAYEY GRAVEL AND SAND</td> <td>SILTY SOILS</td> <td>CLAYEY SOILS</td> <td></td> <td></td> <td></td> <td></td> <td></td> <td></td> <td></td> <td></td> <td></td> <td></td> <td></td> <td></td> <td></td> <td></td> <td></td> <td></td> </tr> <tr> <td>GEN. RATING AS SUBGRADE</td> <td colspan="3">EXCELLENT TO GOOD</td> <td colspan="3">FAIR TO POOR</td> <td>FAIR TO POOR</td> <td>POOR</td> <td>UNSATURABLE</td> <td></td> <td></td> <td></td> <td></td> <td></td> <td></td> <td></td> <td></td> <td></td> <td></td> <td></td> <td></td> </tr> <tr> <td colspan="22" style="text-align: center;">PI OF A-7-5 SUBGROUP IS ≤ LL - 30 ; PI OF A-7-6 SUBGROUP IS > LL - 30</td> </tr> </tbody> </table>	GENERAL CLASS.	GRANULAR MATERIALS (≤ 35% PASSING #200)							SILT-CLAY MATERIALS (> 35% PASSING #200)					ORGANIC MATERIALS			A-1	A-3	A-2	A-4	A-5	A-6	A-7	A-1, A-2	A-3	A-4, A-5	A-6, A-7					GROUP CLASS.	A-1-a	A-1-b	A-2-4	A-2-5	A-2-6	A-2-7	A-4	A-5	A-6	A-7	A-7.5	A-7.6	A-1, A-2	A-3	A-4, A-5	A-6, A-7					SYMBOL																					% PASSING #10 #40 #200	50 MX 30 MX 15 MX	50 MX 25 MX 15 MX	51 MN 35 MX 35 MX	51 MN 35 MX 35 MX	51 MN 35 MX 35 MX	51 MN 35 MX 35 MX	36 MN 36 MN 36 MN	36 MN 36 MN 36 MN	36 MN 36 MN 36 MN	36 MN 36 MN 36 MN	36 MN 36 MN 36 MN	36 MN 36 MN 36 MN	GRANULAR SOILS	SILT-CLAY SOILS	MUCK, PEAT							MATERIAL PASSING #40 LL PI	-	-	40 MX 10 MN	41 MN 10 MN	40 MX 11 MN	41 MN 11 MN	40 MX 10 MN	41 MN 10 MN	40 MX 11 MN	41 MN 11 MN	40 MX 10 MN	41 MN 10 MN	SOILS WITH LITTLE OR MODERATE AMOUNTS OF ORGANIC MATTER	HIGHLY ORGANIC SOILS								GROUP INDEX	0	0	0	0	0	0	0	0	0	0	0	0										USUAL TYPES OF MAJOR MATERIALS	STONE GRAVEL AND SAND	FINE SAND	SILTY OR CLAYEY GRAVEL AND SAND	SILTY SOILS	CLAYEY SOILS																	GEN. RATING AS SUBGRADE	EXCELLENT TO GOOD			FAIR TO POOR			FAIR TO POOR	POOR	UNSATURABLE													PI OF A-7-5 SUBGROUP IS ≤ LL - 30 ; PI OF A-7-6 SUBGROUP IS > LL - 30																						<p style="text-align: center;">MINERALOGICAL COMPOSITION</p> <p>MINERAL NAMES SUCH AS QUARTZ, FELDSPAR, MICA, TALC, KAOLIN, ETC. ARE USED IN DESCRIPTIONS WHEN THEY ARE CONSIDERED OF SIGNIFICANCE.</p> <p style="text-align: center;">COMPRESSIBILITY</p> <p>SLIGHTLY COMPRESSIBLE LL < 31 MODERATELY COMPRESSIBLE LL = 31 - 50 HIGHLY COMPRESSIBLE LL > 50</p> <p style="text-align: center;">PERCENTAGE OF MATERIAL</p> <table border="1" style="width: 100%; border-collapse: collapse;"> <thead> <tr> <th></th> <th>GRANULAR SOILS</th> <th>SILT - CLAY SOILS</th> <th>OTHER MATERIAL</th> </tr> </thead> <tbody> <tr> <td>ORGANIC MATERIAL</td> <td></td> <td></td> <td></td> </tr> <tr> <td>TRACE OF ORGANIC MATTER</td> <td>2 - 3%</td> <td>3 - 5%</td> <td>TRACE 1 - 10%</td> </tr> <tr> <td>LITTLE ORGANIC MATTER</td> <td>3 - 5%</td> <td>5 - 12%</td> <td>LITTLE 10 - 20%</td> </tr> <tr> <td>MODERATELY ORGANIC</td> <td>5 - 10%</td> <td>12 - 20%</td> <td>SOME 20 - 35%</td> </tr> <tr> <td>HIGHLY ORGANIC</td> <td>> 10%</td> <td>> 20%</td> <td>HIGHLY 35% AND ABOVE</td> </tr> </tbody> </table> <p style="text-align: center;">GROUND WATER</p> <p> WATER LEVEL IN BORE HOLE IMMEDIATELY AFTER DRILLING</p> <p> STATIC WATER LEVEL AFTER 24 HOURS</p> <p> PERCHED WATER, SATURATED ZONE, OR WATER BEARING STRATA</p> <p> SPRING OR SEEP</p> <p style="text-align: center;">MISCELLANEOUS SYMBOLS</p> <table border="1" style="width: 100%; border-collapse: collapse;"> <tbody> <tr> <td></td> <td>25/025 DIP & DIP DIRECTION OF ROCK STRUCTURES</td> <td></td> <td></td> <td></td> </tr> <tr> <td></td> <td></td> <td></td> <td></td> <td></td> </tr> <tr> <td></td> <td></td> <td></td> <td></td> <td></td> </tr> <tr> <td></td> <td></td> <td></td> <td></td> <td></td> </tr> <tr> <td></td> <td></td> <td></td> <td></td> <td></td> </tr> </tbody> </table>		GRANULAR SOILS	SILT - CLAY SOILS	OTHER MATERIAL	ORGANIC MATERIAL				TRACE OF ORGANIC MATTER	2 - 3%	3 - 5%	TRACE 1 - 10%	LITTLE ORGANIC MATTER	3 - 5%	5 - 12%	LITTLE 10 - 20%	MODERATELY ORGANIC	5 - 10%	12 - 20%	SOME 20 - 35%	HIGHLY ORGANIC	> 10%	> 20%	HIGHLY 35% AND ABOVE		25/025 DIP & DIP DIRECTION OF ROCK STRUCTURES																								<p style="text-align: center;">WEATHERING</p> <p>FRESH - ROCK FRESH, CRYSTALS BRIGHT, FEW JOINTS MAY SHOW SLIGHT STAINING. ROCK RINGS UNDER HAMMER IF CRYSTALLINE.</p> <p>VERY SLIGHT (V SL.) - ROCK GENERALLY FRESH, JOINTS STAINED, SOME JOINTS MAY SHOW THIN CLAY COATINGS IF OPEN. CRYSTALS ON A BROKEN SPECIMEN FACE SHINE BRIGHTLY. ROCK RINGS UNDER HAMMER BLOWS IF OF A CRYSTALLINE NATURE.</p> <p>SLIGHT (SL.) - ROCK GENERALLY FRESH, JOINTS STAINED AND DISCOLORATION EXTENDS INTO ROCK UP TO 1 INCH. OPEN JOINTS MAY CONTAIN CLAY. IN GRANITOID ROCKS SOME OCCASIONAL FELDSPAR CRYSTALS ARE DULL AND DISCOLORED. CRYSTALLINE ROCKS RING UNDER HAMMER BLOWS.</p> <p>MODERATE (MOD.) - SIGNIFICANT PORTIONS OF ROCK SHOW DISCOLORATION AND WEATHERING EFFECTS. IN GRANITOID ROCKS, MOST FELDSPARS ARE DULL AND DISCOLORED, SOME SHOW CLAY. ROCK HAS DULL SOUND UNDER HAMMER BLOWS AND SHOWS SIGNIFICANT LOSS OF STRENGTH AS COMPARED WITH FRESH ROCK.</p> <p>MODERATELY SEVERE (MOD. SEV.) - ALL ROCK EXCEPT QUARTZ DISCOLORED OR STAINED. IN GRANITOID ROCKS, ALL FELDSPARS DULL AND DISCOLORED AND A MAJORITY SHOW KAOLINIZATION. ROCK SHOWS SEVERE LOSS OF STRENGTH AND CAN BE EXCAVATED WITH A GEOLOGIST'S PICK. ROCK GIVES "CLUNK" SOUND WHEN STRUCK. <i>IF TESTED, WOULD YIELD SPT REFUSAL</i></p> <p>SEVERE (SEV.) - ALL ROCK EXCEPT QUARTZ DISCOLORED OR STAINED. ROCK FABRIC CLEAR AND EVIDENT BUT REDUCED IN STRENGTH TO STRONG SOIL. IN GRANITOID ROCKS ALL FELDSPARS ARE KAOLINIZED TO SOME EXTENT. SOME FRAGMENTS OF STRONG ROCK USUALLY REMAIN. <i>IF TESTED, WOULD YIELD SPT N VALUES > 100 BPF</i></p> <p>VERY SEVERE (V SEV.) - ALL ROCK EXCEPT QUARTZ DISCOLORED OR STAINED. ROCK FABRIC ELEMENTS ARE DISCERNIBLE BUT MASS IS EFFECTIVELY REDUCED TO SOIL STATUS, WITH ONLY FRAGMENTS OF STRONG ROCK REMAINING. SAPROLITE IS AN EXAMPLE OF ROCK WEATHERED TO A DEGREE THAT ONLY MINOR VESTIGES OF ORIGINAL ROCK FABRIC REMAIN. <i>IF TESTED, WOULD YIELD SPT N VALUES < 100 BPF</i></p> <p>COMPLETE - ROCK REDUCED TO SOIL. ROCK FABRIC NOT DISCERNIBLE, OR DISCERNIBLE ONLY IN SMALL AND SCATTERED CONCENTRATIONS. QUARTZ MAY BE PRESENT AS DIKES OR STRINGERS. SAPROLITE IS ALSO AN EXAMPLE.</p> <p style="text-align: center;">ROCK HARDNESS</p> <p>VERY HARD - CANNOT BE SCRATCHED BY KNIFE OR SHARP PICK. BREAKING OF HAND SPECIMENS REQUIRES SEVERAL HARD BLOWS OF THE GEOLOGIST'S PICK.</p> <p>HARD - CAN BE SCRATCHED BY KNIFE OR PICK ONLY WITH DIFFICULTY. HARD HAMMER BLOWS REQUIRED TO DETACH HAND SPECIMEN.</p> <p>MODERATELY HARD - CAN BE SCRATCHED BY KNIFE OR PICK. GOUGES OR GROOVES TO 0.25 INCHES DEEP CAN BE EXCAVATED BY HARD BLOW OF A GEOLOGIST'S PICK. HAND SPECIMENS CAN BE DETACHED BY MODERATE BLOWS.</p> <p>MEDIUM HARD - CAN BE GROUDED OR GOUGED 0.05 INCHES DEEP BY FIRM PRESSURE OF KNIFE OR PICK POINT. CAN BE EXCAVATED IN SMALL CHIPS TO PIECES 1 INCH MAXIMUM SIZE BY HARD BLOWS OF THE POINT OF A GEOLOGIST'S PICK.</p> <p>SOFT - CAN BE GROUDED OR GOUGED READILY BY KNIFE OR PICK. CAN BE EXCAVATED IN FRAGMENTS FROM CHIPS TO SEVERAL INCHES IN SIZE BY MODERATE BLOWS OF A PICK POINT. SMALL, THIN PIECES CAN BE BROKEN BY FINGER PRESSURE.</p> <p>VERY SOFT - CAN BE CARVED WITH KNIFE. CAN BE EXCAVATED READILY WITH POINT OF PICK. PIECES 1 INCH OR MORE IN THICKNESS CAN BE BROKEN BY FINGER PRESSURE. CAN BE SCRATCHED READILY BY FINGERNAIL.</p> <table border="1" style="width: 100%; border-collapse: collapse;"> <thead> <tr> <th colspan="2">FRACTURE SPACING</th> <th colspan="2">BEDDING</th> </tr> <tr> <th>TERM</th> <th>SPACING</th> <th>TERM</th> <th>THICKNESS</th> </tr> </thead> <tbody> <tr> <td>VERY WIDE</td> <td>MORE THAN 10 FEET</td> <td>VERY THICKLY BEDDED</td> <td>4 FEET</td> </tr> <tr> <td>WIDE</td> <td>3 TO 10 FEET</td> <td>THICKLY BEDDED</td> <td>1.5 - 4 FEET</td> </tr> <tr> <td>MODERATELY CLOSE</td> <td>1 TO 3 FEET</td> <td>THINLY BEDDED</td> <td>0.16 - 1.5 FEET</td> </tr> <tr> <td>CLOSE</td> <td>0.16 TO 1 FOOT</td> <td>VERY THINLY BEDDED</td> <td>0.03 - 0.16 FEET</td> </tr> <tr> <td>VERY CLOSE</td> <td>LESS THAN 0.16 FEET</td> <td>THICKLY LAMINATED</td> <td>0.008 - 0.03 FEET</td> </tr> <tr> <td></td> <td></td> <td>THINLY LAMINATED</td> <td>< 0.008 FEET</td> </tr> </tbody> </table> <p style="text-align: center;">INDURATION</p> <p>FOR SEDIMENTARY ROCKS, INDURATION IS THE HARDENING OF MATERIAL BY CEMENTING, HEAT, PRESSURE, ETC.</p> <p>FRIABLE - RUBBING WITH FINGER FREES NUMEROUS GRAINS; GENTLE BLOW BY HAMMER DISINTEGRATES SAMPLE.</p> <p>MODERATELY INDURATED - GRAINS CAN BE SEPARATED FROM SAMPLE WITH STEEL PROBE; BREAKS EASILY WHEN HIT WITH HAMMER.</p> <p>INDURATED - GRAINS ARE DIFFICULT TO SEPARATE WITH STEEL PROBE; DIFFICULT TO BREAK WITH HAMMER.</p> <p>EXTREMELY INDURATED - SHARP HAMMER BLOWS REQUIRED TO BREAK SAMPLE; SAMPLE BREAKS ACROSS GRAINS.</p>	FRACTURE SPACING		BEDDING		TERM	SPACING	TERM	THICKNESS	VERY WIDE	MORE THAN 10 FEET	VERY THICKLY BEDDED	4 FEET	WIDE	3 TO 10 FEET	THICKLY BEDDED	1.5 - 4 FEET	MODERATELY CLOSE	1 TO 3 FEET	THINLY BEDDED	0.16 - 1.5 FEET	CLOSE	0.16 TO 1 FOOT	VERY THINLY BEDDED	0.03 - 0.16 FEET	VERY CLOSE	LESS THAN 0.16 FEET	THICKLY LAMINATED	0.008 - 0.03 FEET			THINLY LAMINATED	< 0.008 FEET
GENERAL CLASS.		GRANULAR MATERIALS (≤ 35% PASSING #200)							SILT-CLAY MATERIALS (> 35% PASSING #200)					ORGANIC MATERIALS																																																																																																																																																																																																																																																																																		
	A-1	A-3	A-2	A-4	A-5	A-6	A-7	A-1, A-2	A-3	A-4, A-5	A-6, A-7																																																																																																																																																																																																																																																																																					
GROUP CLASS.	A-1-a	A-1-b	A-2-4	A-2-5	A-2-6	A-2-7	A-4	A-5	A-6	A-7	A-7.5	A-7.6	A-1, A-2	A-3	A-4, A-5	A-6, A-7																																																																																																																																																																																																																																																																																
SYMBOL																																																																																																																																																																																																																																																																																																
% PASSING #10 #40 #200	50 MX 30 MX 15 MX	50 MX 25 MX 15 MX	51 MN 35 MX 35 MX	51 MN 35 MX 35 MX	51 MN 35 MX 35 MX	51 MN 35 MX 35 MX	36 MN 36 MN 36 MN	36 MN 36 MN 36 MN	36 MN 36 MN 36 MN	36 MN 36 MN 36 MN	36 MN 36 MN 36 MN	36 MN 36 MN 36 MN	GRANULAR SOILS	SILT-CLAY SOILS	MUCK, PEAT																																																																																																																																																																																																																																																																																	
MATERIAL PASSING #40 LL PI	-	-	40 MX 10 MN	41 MN 10 MN	40 MX 11 MN	41 MN 11 MN	40 MX 10 MN	41 MN 10 MN	40 MX 11 MN	41 MN 11 MN	40 MX 10 MN	41 MN 10 MN	SOILS WITH LITTLE OR MODERATE AMOUNTS OF ORGANIC MATTER	HIGHLY ORGANIC SOILS																																																																																																																																																																																																																																																																																		
GROUP INDEX	0	0	0	0	0	0	0	0	0	0	0	0																																																																																																																																																																																																																																																																																				
USUAL TYPES OF MAJOR MATERIALS	STONE GRAVEL AND SAND	FINE SAND	SILTY OR CLAYEY GRAVEL AND SAND	SILTY SOILS	CLAYEY SOILS																																																																																																																																																																																																																																																																																											
GEN. RATING AS SUBGRADE	EXCELLENT TO GOOD			FAIR TO POOR			FAIR TO POOR	POOR	UNSATURABLE																																																																																																																																																																																																																																																																																							
PI OF A-7-5 SUBGROUP IS ≤ LL - 30 ; PI OF A-7-6 SUBGROUP IS > LL - 30																																																																																																																																																																																																																																																																																																
	GRANULAR SOILS	SILT - CLAY SOILS	OTHER MATERIAL																																																																																																																																																																																																																																																																																													
ORGANIC MATERIAL																																																																																																																																																																																																																																																																																																
TRACE OF ORGANIC MATTER	2 - 3%	3 - 5%	TRACE 1 - 10%																																																																																																																																																																																																																																																																																													
LITTLE ORGANIC MATTER	3 - 5%	5 - 12%	LITTLE 10 - 20%																																																																																																																																																																																																																																																																																													
MODERATELY ORGANIC	5 - 10%	12 - 20%	SOME 20 - 35%																																																																																																																																																																																																																																																																																													
HIGHLY ORGANIC	> 10%	> 20%	HIGHLY 35% AND ABOVE																																																																																																																																																																																																																																																																																													
	25/025 DIP & DIP DIRECTION OF ROCK STRUCTURES																																																																																																																																																																																																																																																																																															
FRACTURE SPACING		BEDDING																																																																																																																																																																																																																																																																																														
TERM	SPACING	TERM	THICKNESS																																																																																																																																																																																																																																																																																													
VERY WIDE	MORE THAN 10 FEET	VERY THICKLY BEDDED	4 FEET																																																																																																																																																																																																																																																																																													
WIDE	3 TO 10 FEET	THICKLY BEDDED	1.5 - 4 FEET																																																																																																																																																																																																																																																																																													
MODERATELY CLOSE	1 TO 3 FEET	THINLY BEDDED	0.16 - 1.5 FEET																																																																																																																																																																																																																																																																																													
CLOSE	0.16 TO 1 FOOT	VERY THINLY BEDDED	0.03 - 0.16 FEET																																																																																																																																																																																																																																																																																													
VERY CLOSE	LESS THAN 0.16 FEET	THICKLY LAMINATED	0.008 - 0.03 FEET																																																																																																																																																																																																																																																																																													
		THINLY LAMINATED	< 0.008 FEET																																																																																																																																																																																																																																																																																													
<p style="text-align: center;">CONSISTENCY OR DENSENESS</p> <table border="1" style="width: 100%; border-collapse: collapse;"> <thead> <tr> <th>PRIMARY SOIL TYPE</th> <th>COMPACTNESS OR CONSISTENCY</th> <th>RANGE OF STANDARD PENETRATION RESISTANCE (N-VALUE)</th> <th>RANGE OF UNCONFINED COMPRESSIVE STRENGTH (TONS/FT²)</th> </tr> </thead> <tbody> <tr> <td>GENERALLY GRANULAR MATERIAL (NON-COHESIVE)</td> <td>VERY LOOSE LOOSE MEDIUM DENSE DENSE VERY DENSE</td> <td>< 4 4 TO 10 10 TO 30 30 TO 50 > 50</td> <td>N/A</td> </tr> <tr> <td>GENERALLY SILT-CLAY MATERIAL (COHESIVE)</td> <td>VERY SOFT SOFT MEDIUM STIFF STIFF VERY STIFF HARD</td> <td>< 2 2 TO 4 4 TO 8 8 TO 15 15 TO 30 > 30</td> <td>< 0.25 0.25 TO 0.5 0.5 TO 1.0 1 TO 2 2 TO 4 > 4</td> </tr> </tbody> </table> <p style="text-align: center;">TEXTURE OR GRAIN SIZE</p> <table border="1" style="width: 100%; border-collapse: collapse;"> <thead> <tr> <th>U.S. STD. SIEVE SIZE OPENING (MM)</th> <th>4</th> <th>10</th> <th>40</th> <th>60</th> <th>200</th> <th>270</th> </tr> </thead> <tbody> <tr> <td></td> <td>4.76</td> <td>2.00</td> <td>0.42</td> <td>0.25</td> <td>0.075</td> <td>0.053</td> </tr> </tbody> </table> <table border="1" style="width: 100%; border-collapse: collapse;"> <thead> <tr> <th>BOULDER (BLDR.)</th> <th>COBBLE (COB.)</th> <th>GRAVEL (GR.)</th> <th>COARSE SAND (CS, SD.)</th> <th>FINE SAND (F SD.)</th> <th>SILT (SL.)</th> <th>CLAY (CL.)</th> </tr> </thead> <tbody> <tr> <td>305</td> <td>75</td> <td>2.0</td> <td>0.25</td> <td>0.05</td> <td>0.005</td> <td></td> </tr> <tr> <td>IN. 12</td> <td>3</td> <td></td> <td></td> <td></td> <td></td> <td></td> </tr> </tbody> </table> <p style="text-align: center;">SOIL MOISTURE - CORRELATION OF TERMS</p> <table border="1" style="width: 100%; border-collapse: collapse;"> <thead> <tr> <th>SOIL MOISTURE SCALE (ATTERBERG LIMITS)</th> <th>FIELD MOISTURE DESCRIPTION</th> <th>GUIDE FOR FIELD MOISTURE DESCRIPTION</th> </tr> </thead> <tbody> <tr> <td>- SATURATED - (SAT.)</td> <td></td> <td>USUALLY LIQUID; VERY WET, USUALLY FROM BELOW THE GROUND WATER TABLE</td> </tr> <tr> <td>- WET - (W)</td> <td></td> <td>SEMISOLID; REQUIRES DRYING TO ATTAIN OPTIMUM MOISTURE</td> </tr> <tr> <td>- MOIST - (M)</td> <td></td> <td>SOLID; AT OR NEAR OPTIMUM MOISTURE</td> </tr> <tr> <td>- DRY - (D)</td> <td></td> <td>REQUIRES ADDITIONAL WATER TO ATTAIN OPTIMUM MOISTURE</td> </tr> </tbody> </table> <p style="text-align: center;">PLASTICITY</p> <table border="1" style="width: 100%; border-collapse: collapse;"> <thead> <tr> <th>NON PLASTIC</th> <th>PLASTICITY INDEX (PI)</th> <th>DRY STRENGTH</th> </tr> </thead> <tbody> <tr> <td>SLIGHTLY PLASTIC</td> <td>0-5</td> <td>VERY LOW</td> </tr> <tr> <td>MODERATELY PLASTIC</td> <td>6-15</td> <td>SLIGHT</td> </tr> <tr> <td>HIGHLY PLASTIC</td> <td>16-25</td> <td>MEDIUM</td> </tr> <tr> <td></td> <td>26 OR MORE</td> <td>HIGH</td> </tr> </tbody> </table> <p style="text-align: center;">COLOR</p> <p>DESCRIPTIONS MAY INCLUDE COLOR OR COLOR COMBINATIONS (TAN, RED, YELLOW-BROWN, BLUE-GRAY). MODIFIERS SUCH AS LIGHT, DARK, STREAKED, ETC. ARE USED TO DESCRIBE APPEARANCE.</p>	PRIMARY SOIL TYPE	COMPACTNESS OR CONSISTENCY	RANGE OF STANDARD PENETRATION RESISTANCE (N-VALUE)	RANGE OF UNCONFINED COMPRESSIVE STRENGTH (TONS/FT ²)	GENERALLY GRANULAR MATERIAL (NON-COHESIVE)	VERY LOOSE LOOSE MEDIUM DENSE DENSE VERY DENSE	< 4 4 TO 10 10 TO 30 30 TO 50 > 50	N/A	GENERALLY SILT-CLAY MATERIAL (COHESIVE)	VERY SOFT SOFT MEDIUM STIFF STIFF VERY STIFF HARD	< 2 2 TO 4 4 TO 8 8 TO 15 15 TO 30 > 30	< 0.25 0.25 TO 0.5 0.5 TO 1.0 1 TO 2 2 TO 4 > 4	U.S. STD. SIEVE SIZE OPENING (MM)	4	10	40	60	200	270		4.76	2.00	0.42	0.25	0.075	0.053	BOULDER (BLDR.)	COBBLE (COB.)	GRAVEL (GR.)	COARSE SAND (CS, SD.)	FINE SAND (F SD.)	SILT (SL.)	CLAY (CL.)	305	75	2.0	0.25	0.05	0.005		IN. 12	3						SOIL MOISTURE SCALE (ATTERBERG LIMITS)	FIELD MOISTURE DESCRIPTION	GUIDE FOR FIELD MOISTURE DESCRIPTION	- SATURATED - (SAT.)		USUALLY LIQUID; VERY WET, USUALLY FROM BELOW THE GROUND WATER TABLE	- WET - (W)		SEMISOLID; REQUIRES DRYING TO ATTAIN OPTIMUM MOISTURE	- MOIST - (M)		SOLID; AT OR NEAR OPTIMUM MOISTURE	- DRY - (D)		REQUIRES ADDITIONAL WATER TO ATTAIN OPTIMUM MOISTURE	NON PLASTIC	PLASTICITY INDEX (PI)	DRY STRENGTH	SLIGHTLY PLASTIC	0-5	VERY LOW	MODERATELY PLASTIC	6-15	SLIGHT	HIGHLY PLASTIC	16-25	MEDIUM		26 OR MORE	HIGH	<p style="text-align: center;">RECOMMENDATION SYMBOLS</p> <table border="1" style="width: 100%; border-collapse: collapse;"> <tbody> <tr> <td></td> <td></td> <td></td> </tr> <tr> <td></td> <td></td> <td></td> </tr> </tbody> </table> <p style="text-align: center;">ABBREVIATIONS</p> <table border="1" style="width: 100%; border-collapse: collapse;"> <tbody> <tr> <td>AR - AUGER REFUSAL</td> <td>MED. - MEDIUM</td> <td>VST - VANE SHEAR TEST</td> </tr> <tr> <td>BT - BORING TERMINATED</td> <td>MICA - MICACEOUS</td> <td>WEA. - WEATHERED</td> </tr> <tr> <td>CL - CLAY</td> <td>MOD. - MODERATELY</td> <td>W - UNIT WEIGHT</td> </tr> <tr> <td>CPT - CONE PENETRATION TEST</td> <td>NP - NON PLASTIC</td> <td>W_g - DRY UNIT WEIGHT</td> </tr> <tr> <td>CSE - COARSE</td> <td>ORG. - ORGANIC</td> <td></td> </tr> <tr> <td>DMT - DILATOMETER TEST</td> <td>PMT - PRESSUREMETER TEST</td> <td>SAMPLE ABBREVIATIONS</td> </tr> <tr> <td>DPT - DYNAMIC PENETRATION TEST</td> <td>SAP. - SAPROLITIC</td> <td>S - BULK</td> </tr> <tr> <td>e - VOID RATIO</td> <td>SD. - SAND, SANDY</td> <td>SS - SPLIT SPOON</td> </tr> <tr> <td>F - FINE</td> <td>SL. - SILT, SILTY</td> <td>ST - SHELBY TUBE</td> </tr> <tr> <td>FOSS. - FOSSILIFEROUS</td> <td>SLI. - SLIGHTLY</td> <td>RS - ROCK</td> </tr> <tr> <td>FRAC. - FRACTURED, FRACTURES</td> <td>TCR - TRICONE REFUSAL</td> <td>RT - RECOMPACTED TRIAXIAL</td> </tr> <tr> <td>FRAGS. - FRAGMENTS</td> <td>w - MOISTURE CONTENT</td> <td>CBR - CALIFORNIA BEARING RATIO</td> </tr> <tr> <td>HL - HIGHLY</td> <td>V - VERY</td> <td></td> </tr> </tbody> </table> <p style="text-align: center;">EQUIPMENT USED ON SUBJECT PROJECT</p> <table border="1" style="width: 100%; border-collapse: collapse;"> <thead> <tr> <th>DRILL UNITS:</th> <th>ADVANCING TOOLS:</th> <th>HAMMER TYPE:</th> </tr> </thead> <tbody> <tr> <td><input checked="" type="checkbox"/> CME-45C</td> <td><input type="checkbox"/> CLAY BITS</td> <td><input checked="" type="checkbox"/> AUTOMATIC <input type="checkbox"/> MANUAL</td> </tr> <tr> <td><input type="checkbox"/> CME-55</td> <td><input type="checkbox"/> 6" CONTINUOUS FLIGHT AUGER</td> <td></td> </tr> <tr> <td><input type="checkbox"/> CME-550</td> <td><input type="checkbox"/> 8" HOLLOW AUGERS</td> <td></td> </tr> <tr> <td><input type="checkbox"/> VANE SHEAR TEST</td> <td><input type="checkbox"/> HARD FACED FINGER BITS</td> <td></td> </tr> <tr> <td><input type="checkbox"/> PORTABLE HOIST</td> <td><input type="checkbox"/> TUNG-CARBIDE INSERTS</td> <td></td> </tr> <tr> <td></td> <td><input checked="" type="checkbox"/> CASING <input type="checkbox"/> W/ ADVANCER</td> <td></td> </tr> <tr> <td></td> <td><input checked="" type="checkbox"/> TRICONE <input type="checkbox"/> 2 1/8" STEEL TEETH</td> <td></td> </tr> <tr> <td></td> <td><input type="checkbox"/> TRICONE <input type="checkbox"/> TUNG-CARB.</td> <td></td> </tr> <tr> <td></td> <td><input type="checkbox"/> CORE BIT</td> <td></td> </tr> <tr> <td></td> <td></td> <td></td> </tr> </tbody> </table> <p style="text-align: center;">INDURATION</p> <p>FOR SEDIMENTARY ROCKS, INDURATION IS THE HARDENING OF MATERIAL BY CEMENTING, HEAT, PRESSURE, ETC.</p> <p>FRIABLE - RUBBING WITH FINGER FREES NUMEROUS GRAINS; GENTLE BLOW BY HAMMER DISINTEGRATES SAMPLE.</p> <p>MODERATELY INDURATED - GRAINS CAN BE SEPARATED FROM SAMPLE WITH STEEL PROBE; BREAKS EASILY WHEN HIT WITH HAMMER.</p> <p>INDURATED - GRAINS ARE DIFFICULT TO SEPARATE WITH STEEL PROBE; DIFFICULT TO BREAK WITH HAMMER.</p> <p>EXTREMELY INDURATED - SHARP HAMMER BLOWS REQUIRED TO BREAK SAMPLE; SAMPLE BREAKS ACROSS GRAINS.</p>							AR - AUGER REFUSAL	MED. - MEDIUM	VST - VANE SHEAR TEST	BT - BORING TERMINATED	MICA - MICACEOUS	WEA. - WEATHERED	CL - CLAY	MOD. - MODERATELY	W - UNIT WEIGHT	CPT - CONE PENETRATION TEST	NP - NON PLASTIC	W _g - DRY UNIT WEIGHT	CSE - COARSE	ORG. - ORGANIC		DMT - DILATOMETER TEST	PMT - PRESSUREMETER TEST	SAMPLE ABBREVIATIONS	DPT - DYNAMIC PENETRATION TEST	SAP. - SAPROLITIC	S - BULK	e - VOID RATIO	SD. - SAND, SANDY	SS - SPLIT SPOON	F - FINE	SL. - SILT, SILTY	ST - SHELBY TUBE	FOSS. - FOSSILIFEROUS	SLI. - SLIGHTLY	RS - ROCK	FRAC. - FRACTURED, FRACTURES	TCR - TRICONE REFUSAL	RT - RECOMPACTED TRIAXIAL	FRAGS. - FRAGMENTS	w - MOISTURE CONTENT	CBR - CALIFORNIA BEARING RATIO	HL - HIGHLY	V - VERY		DRILL UNITS:	ADVANCING TOOLS:	HAMMER TYPE:	<input checked="" type="checkbox"/> CME-45C	<input type="checkbox"/> CLAY BITS	<input checked="" type="checkbox"/> AUTOMATIC <input type="checkbox"/> MANUAL	<input type="checkbox"/> CME-55	<input type="checkbox"/> 6" CONTINUOUS FLIGHT AUGER		<input type="checkbox"/> CME-550	<input type="checkbox"/> 8" HOLLOW AUGERS		<input type="checkbox"/> VANE SHEAR TEST	<input type="checkbox"/> HARD FACED FINGER BITS		<input type="checkbox"/> PORTABLE HOIST	<input type="checkbox"/> TUNG-CARBIDE INSERTS			<input checked="" type="checkbox"/> CASING <input type="checkbox"/> W/ ADVANCER			<input checked="" type="checkbox"/> TRICONE <input type="checkbox"/> 2 1/8" STEEL TEETH			<input type="checkbox"/> TRICONE <input type="checkbox"/> TUNG-CARB.			<input type="checkbox"/> CORE BIT																																																																																																																																								
PRIMARY SOIL TYPE	COMPACTNESS OR CONSISTENCY	RANGE OF STANDARD PENETRATION RESISTANCE (N-VALUE)	RANGE OF UNCONFINED COMPRESSIVE STRENGTH (TONS/FT ²)																																																																																																																																																																																																																																																																																													
GENERALLY GRANULAR MATERIAL (NON-COHESIVE)	VERY LOOSE LOOSE MEDIUM DENSE DENSE VERY DENSE	< 4 4 TO 10 10 TO 30 30 TO 50 > 50	N/A																																																																																																																																																																																																																																																																																													
GENERALLY SILT-CLAY MATERIAL (COHESIVE)	VERY SOFT SOFT MEDIUM STIFF STIFF VERY STIFF HARD	< 2 2 TO 4 4 TO 8 8 TO 15 15 TO 30 > 30	< 0.25 0.25 TO 0.5 0.5 TO 1.0 1 TO 2 2 TO 4 > 4																																																																																																																																																																																																																																																																																													
U.S. STD. SIEVE SIZE OPENING (MM)	4	10	40	60	200	270																																																																																																																																																																																																																																																																																										
	4.76	2.00	0.42	0.25	0.075	0.053																																																																																																																																																																																																																																																																																										
BOULDER (BLDR.)	COBBLE (COB.)	GRAVEL (GR.)	COARSE SAND (CS, SD.)	FINE SAND (F SD.)	SILT (SL.)	CLAY (CL.)																																																																																																																																																																																																																																																																																										
305	75	2.0	0.25	0.05	0.005																																																																																																																																																																																																																																																																																											
IN. 12	3																																																																																																																																																																																																																																																																																															
SOIL MOISTURE SCALE (ATTERBERG LIMITS)	FIELD MOISTURE DESCRIPTION	GUIDE FOR FIELD MOISTURE DESCRIPTION																																																																																																																																																																																																																																																																																														
- SATURATED - (SAT.)		USUALLY LIQUID; VERY WET, USUALLY FROM BELOW THE GROUND WATER TABLE																																																																																																																																																																																																																																																																																														
- WET - (W)		SEMISOLID; REQUIRES DRYING TO ATTAIN OPTIMUM MOISTURE																																																																																																																																																																																																																																																																																														
- MOIST - (M)		SOLID; AT OR NEAR OPTIMUM MOISTURE																																																																																																																																																																																																																																																																																														
- DRY - (D)		REQUIRES ADDITIONAL WATER TO ATTAIN OPTIMUM MOISTURE																																																																																																																																																																																																																																																																																														
NON PLASTIC	PLASTICITY INDEX (PI)	DRY STRENGTH																																																																																																																																																																																																																																																																																														
SLIGHTLY PLASTIC	0-5	VERY LOW																																																																																																																																																																																																																																																																																														
MODERATELY PLASTIC	6-15	SLIGHT																																																																																																																																																																																																																																																																																														
HIGHLY PLASTIC	16-25	MEDIUM																																																																																																																																																																																																																																																																																														
	26 OR MORE	HIGH																																																																																																																																																																																																																																																																																														
AR - AUGER REFUSAL	MED. - MEDIUM	VST - VANE SHEAR TEST																																																																																																																																																																																																																																																																																														
BT - BORING TERMINATED	MICA - MICACEOUS	WEA. - WEATHERED																																																																																																																																																																																																																																																																																														
CL - CLAY	MOD. - MODERATELY	W - UNIT WEIGHT																																																																																																																																																																																																																																																																																														
CPT - CONE PENETRATION TEST	NP - NON PLASTIC	W _g - DRY UNIT WEIGHT																																																																																																																																																																																																																																																																																														
CSE - COARSE	ORG. - ORGANIC																																																																																																																																																																																																																																																																																															
DMT - DILATOMETER TEST	PMT - PRESSUREMETER TEST	SAMPLE ABBREVIATIONS																																																																																																																																																																																																																																																																																														
DPT - DYNAMIC PENETRATION TEST	SAP. - SAPROLITIC	S - BULK																																																																																																																																																																																																																																																																																														
e - VOID RATIO	SD. - SAND, SANDY	SS - SPLIT SPOON																																																																																																																																																																																																																																																																																														
F - FINE	SL. - SILT, SILTY	ST - SHELBY TUBE																																																																																																																																																																																																																																																																																														
FOSS. - FOSSILIFEROUS	SLI. - SLIGHTLY	RS - ROCK																																																																																																																																																																																																																																																																																														
FRAC. - FRACTURED, FRACTURES	TCR - TRICONE REFUSAL	RT - RECOMPACTED TRIAXIAL																																																																																																																																																																																																																																																																																														
FRAGS. - FRAGMENTS	w - MOISTURE CONTENT	CBR - CALIFORNIA BEARING RATIO																																																																																																																																																																																																																																																																																														
HL - HIGHLY	V - VERY																																																																																																																																																																																																																																																																																															
DRILL UNITS:	ADVANCING TOOLS:	HAMMER TYPE:																																																																																																																																																																																																																																																																																														
<input checked="" type="checkbox"/> CME-45C	<input type="checkbox"/> CLAY BITS	<input checked="" type="checkbox"/> AUTOMATIC <input type="checkbox"/> MANUAL																																																																																																																																																																																																																																																																																														
<input type="checkbox"/> CME-55	<input type="checkbox"/> 6" CONTINUOUS FLIGHT AUGER																																																																																																																																																																																																																																																																																															
<input type="checkbox"/> CME-550	<input type="checkbox"/> 8" HOLLOW AUGERS																																																																																																																																																																																																																																																																																															
<input type="checkbox"/> VANE SHEAR TEST	<input type="checkbox"/> HARD FACED FINGER BITS																																																																																																																																																																																																																																																																																															
<input type="checkbox"/> PORTABLE HOIST	<input type="checkbox"/> TUNG-CARBIDE INSERTS																																																																																																																																																																																																																																																																																															
	<input checked="" type="checkbox"/> CASING <input type="checkbox"/> W/ ADVANCER																																																																																																																																																																																																																																																																																															
	<input checked="" type="checkbox"/> TRICONE <input type="checkbox"/> 2 1/8" STEEL TEETH																																																																																																																																																																																																																																																																																															
	<input type="checkbox"/> TRICONE <input type="checkbox"/> TUNG-CARB.																																																																																																																																																																																																																																																																																															
	<input type="checkbox"/> CORE BIT																																																																																																																																																																																																																																																																																															
<p>BENCH MARK: B4842-1 N=665907.4330 E=2297444.3440 ELEVATION: 99.27 FEET</p> <p>NOTES:</p>			<p style="text-align: right;">DATE: 8-15-14</p>																																																																																																																																																																																																																																																																																													

SKEW = 90°

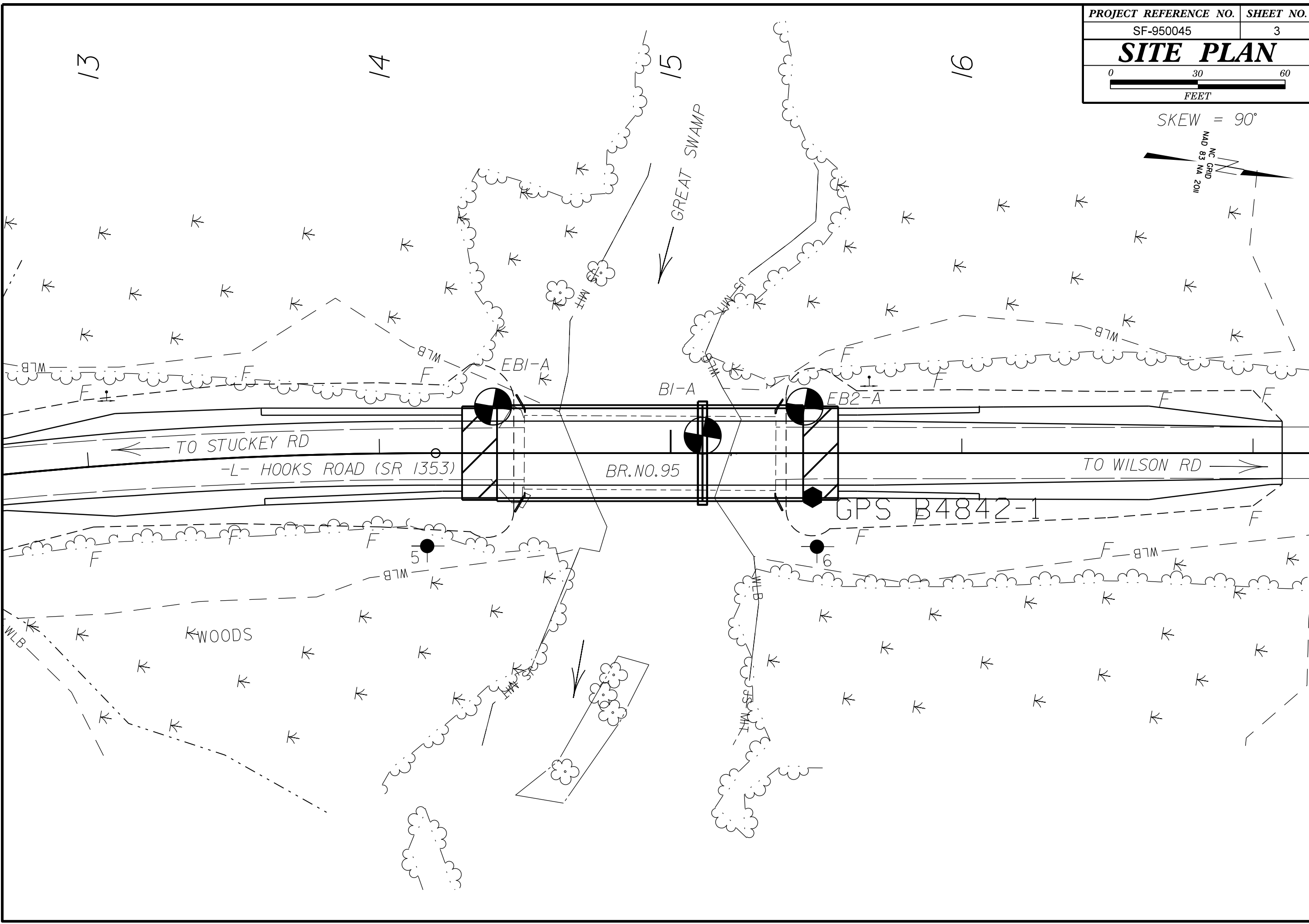
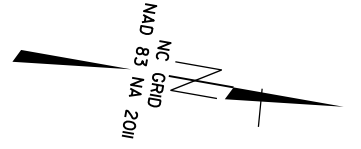

GEOTECHNICAL BORING REPORT

BORE LOG

WBS 17BP.4.R.104		TIP SF-950045		COUNTY WAYNE		GEOLOGIST Cornette, C. J.											
SITE DESCRIPTION BRIDGE NO. 45 ON -L (SR 1353) OVER GREAT SWAMP AT STATION 14+93							GROUND WTR (ft)										
BORING NO. EB2-A		STATION 15+46		OFFSET 16 ft LT		ALIGNMENT -L-											
COLLAR ELEV. 99.6 ft		TOTAL DEPTH 53.5 ft		NORTHING 665,899		EASTING 2,297,414											
DRILL RIG/HAMMER EFF./DATE GFC0075 CME-45C 89% 08/13/2018				DRILL METHOD Mud Rotary		HAMMER TYPE Automatic											
DRILLER Smith, R. E.		START DATE 12/06/18		COMP. DATE 12/06/18		SURFACE WATER DEPTH N/A											
ELEV (ft)	DRIVE ELEV (ft)	DEPTH (ft)	BLOW COUNT			BLOWS PER FOOT					SAMP. NO.	LOG	SOIL AND ROCK DESCRIPTION				
			0.5ft	0.5ft	0.5ft	0	25	50	75	100			ELEV. (ft)	DEPTH (ft)			
100	99.6	0.0	3	5	4									99.6	GROUND SURFACE	0.0	
	95.5	4.1	WOH	WOH	WOH									96.6	ROADWAY EMBANKMENT TAN SAND, MOIST	3.0	
95																	
	91.5	8.1	WOH	1	3									93.6	ALLUVIAL GRAY SILTY SAND WITH WOOD FRAGMENTS, MOIST TO SATURATED	6.0	
90																	
	85.5	14.1	7	6	7									87.8	ALLUVIAL GRAY SANDY CLAY, WET		
85																	
	81.5	18.1	11	17	21												
80																	
	76.5	23.1	12	16	20												
75																	
	71.5	28.1	7	18	23												
70																	
	66.5	33.1	10	19	23												
65																	
	61.5	38.1	15	22	33												
60																	
	56.5	43.1	21	50	50/0.3									58.6	WEATHERED ROCK METAVOLCANIC PHYLLITE	41.0	
55																	
	51.5	48.1	56	60/0.1										53.6	NON-CRYSTALLINE ROCK METAVOLCANIC PHYLLITE	46.0	
50																	
	46.5	53.1	100/0.4											48.6	WEATHERED ROCK METAVOLCANIC PHYLLITE	51.0	
														46.1	WEATHERED ROCK METAVOLCANIC PHYLLITE	53.5	
															Boring Terminated at Elevation 46.1 ft in Weathered Rock		

NCDOT BORE DOUBLE_SF950045_GEO_BRDG0045.GPJ_NC_DOT.GDT 12/19/18